

# GJM0225C1E9R1DB01#

“#” indicates a package specification code.

In Production

General

RoHS

REACH

125 °C max.

High Q

Reflow OK

< List of part numbers with package codes >  
GJM0225C1E9R1DB01L

## Appearance & Shape

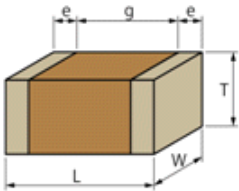
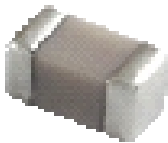

## References

| Packaging | Specifications   | Minimum Order Quantity |
|-----------|------------------|------------------------|
| L         | 180Embossed Tape | 40000                  |

| Mass (typ.) |        |
|-------------|--------|
| 1 piece     | 0.09mg |
| φ180mm Reel | 198g   |

**Attention**  
1.This datasheet is downloaded from the website of Murata Manufacturing Co., Ltd. Therefore, it's specifications are subject to change or our products in it may be discontinued without advance notice. Please check with our sales representatives or product engineers before ordering.  
2.This datasheet has only typical specifications because there is no space for detailed specifications.  
Therefore, please review our product specifications or consult the approval sheet for product specifications before ordering.

# GJM0225C1E9R1DB01#

“#” indicates a package specification code.

## Specifications

|  |                |
|--|----------------|
| Length   | 0.4±0.02mm     |
| Width  | 0.2±0.02mm     |
| Thickness  | 0.2±0.02mm     |
| Capacitance                                      | 9.1pF ±0.5pF   |
| Distance between external terminals g            | 0.13mm min.    |
| External terminal size e                         | 0.07 to 0.14mm |
| Operating Temperature Range                      | -55°C to 125°C |
| Rated Voltage                                    | 25Vdc          |
| Size code in inch(mm)                            | 01005 (0402M)  |
| TC   | 0±30ppm/°C     |
| Temperature characteristics (complied standard)  | C0G(EIA)       |
| Temperature range of temperature characteristics | 25°C to 125°C  |

### Attention

1.This datasheet is downloaded from the website of Murata Manufacturing Co., Ltd. Therefore, it's specifications are subject to change or our products in it may be discontinued without advance notice. Please check with our sales representatives or product engineers before ordering.

2.This datasheet has only typical specifications because there is no space for detailed specifications.

Therefore, please review our product specifications or consult the approval sheet for product specifications before ordering.

# GJM0225C1E9R1DB01#

"#" indicates a package specification code.

## Characteristic Data

The charts below may show another part number which shares its characteristics.

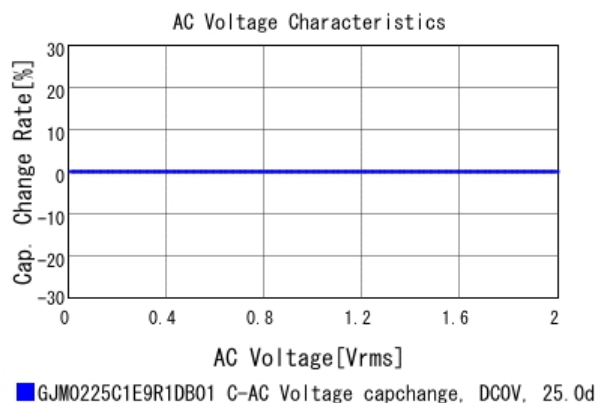
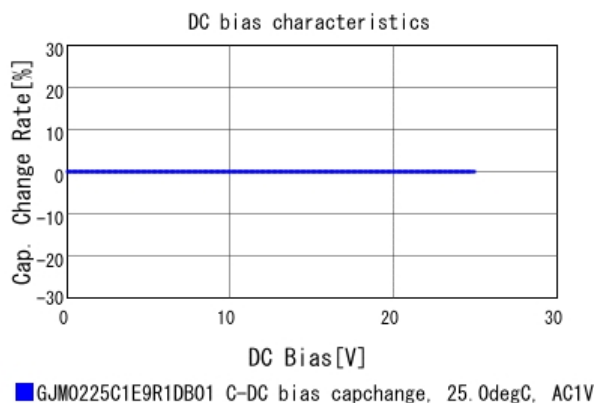
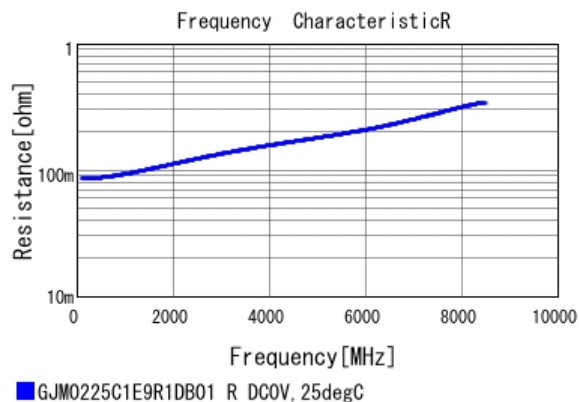
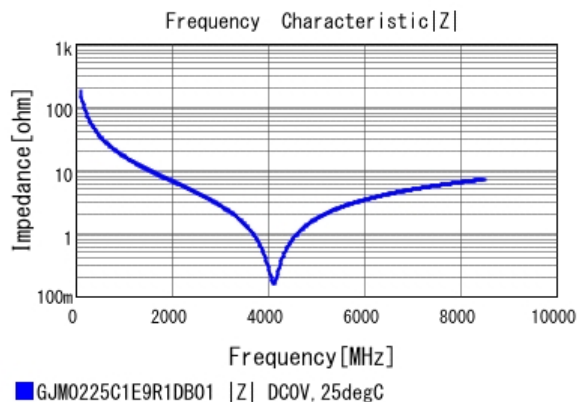

### Attention

- 1.This datasheet is downloaded from the website of Murata Manufacturing Co., Ltd. Therefore, it's specifications are subject to change or our products in it may be discontinued without advance notice. Please check with our sales representatives or product engineers before ordering.
- 2.This datasheet has only typical specifications because there is no space for detailed specifications.  
Therefore, please review our product specifications or consult the approval sheet for product specifications before ordering.

# GJM0225C1E9R1DB01#

“#” indicates a package specification code.

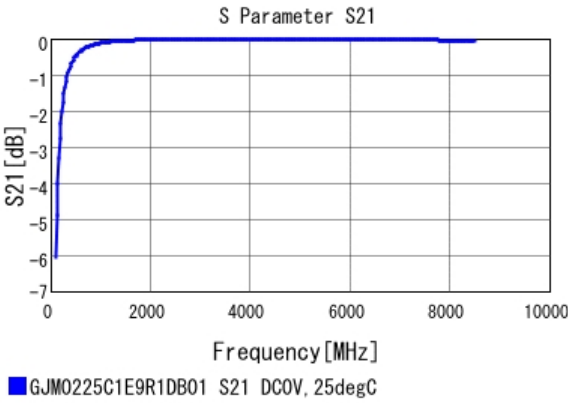
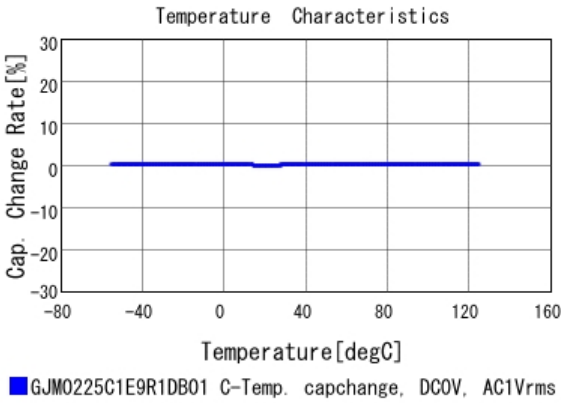

**Attention**  
1.This datasheet is downloaded from the website of Murata Manufacturing Co., Ltd. Therefore, it's specifications are subject to change or our products in it may be discontinued without advance notice. Please check with our sales representatives or product engineers before ordering.  
2.This datasheet has only typical specifications because there is no space for detailed specifications.  
Therefore, please review our product specifications or consult the approval sheet for product specifications before ordering.