

(THM) THRU HOLE MOUNT TEST POINTS - COLOR KEYED

- Color keyed for visibility and quick identification
- Economical choice for PC test point terminations
- Snap-fit mounting provides positive retention for wave soldering
- Wire form loop for safe, non-slip testing
- Space saving, ultra low and low profile designs
- High profile design for difficult to reach applications
- Suitable for high density packaging on .062 (1.57) and .093 (2.36) PC boards
- Practical replacement for wire-wrap posts and turrets
- Secure grip for J hooks, EZ hooks, grabbers, alligator clips, tips or probes
- High temperature nylon base ideal for reflow soldering
- Ideal for reliable production testing and field service troubleshooting

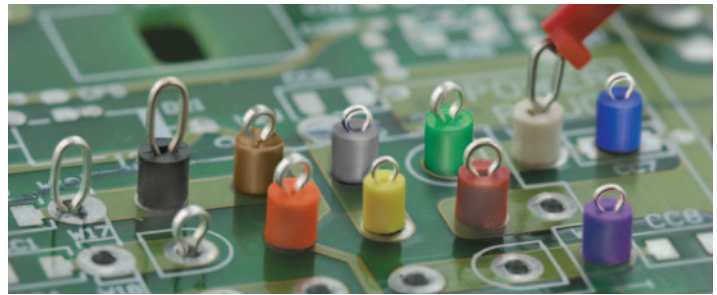

Operating Temperature: -50°F to 185°F (-45°C to 85°C)

MINIATURE

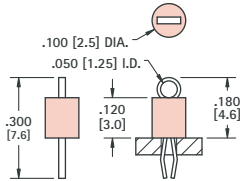

BASE COLOR	Plating	
	SILVER	TIN
RED	5000	5260
BLACK	5001	5261
WHITE	5002	5262
ORANGE	5003	5263
YELLOW	5004	5264
BROWN	5115	5265
GREEN	5116	5266
BLUE	5117	5267
GREY	5118	5268
PURPLE	5119	5269

SPECIFICATIONS

Terminal: .010 (.25) x .020 (.51)
Phosphor Bronze, Silver or Tin Plate
Base: Nylon 46, UL Rated 94V-0
Mtg. Hole: .040 (1.0) Diameter

COLOR KEYED

COMPACT

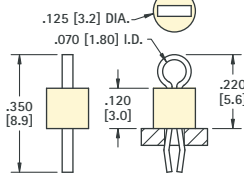

BASE COLOR	Plating	
	SILVER	TIN
RED	5005	5270
BLACK	5006	5271
WHITE	5007	5272
ORANGE	5008	5273
YELLOW	5009	5274
BROWN	5120	5275
GREEN	5121	5276
BLUE	5122	5277
GREY	5123	5278
PURPLE	5124	5279

SPECIFICATIONS

Terminal: .015 (.38) x .032 (.81)
Phosphor Bronze, Silver or Tin Plate
Base: Nylon 46, UL Rated 94V-0
Mtg. Hole: .063 (1.6) Diameter

MULTIPURPOSE

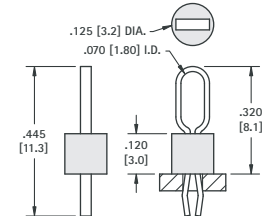

BASE COLOR	Plating	
	SILVER	TIN
RED	5010	5280
BLACK	5011	5281
WHITE	5012	5282
ORANGE	5013	5283
YELLOW	5014	5284
BROWN	5125	5285
GREEN	5126	5286
BLUE	5127	5287
GREY	5128	5288
PURPLE	5129	5289

SPECIFICATIONS

Terminal: .015 (.38) x .032 (.81)
Phosphor Bronze, Silver or Tin Plate
Base: Nylon 46, UL Rated 94V-0
Mtg. Hole: .063 (1.6) Diameter

ULTRA LOW PROFILE

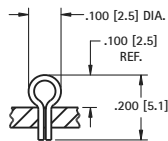

MATERIAL: .017 (.43) Dia. Phosphor Bronze Silver Plate
Mtg Hole: .040 (1.0)

CAT. NO. 5021

LOW PROFILE

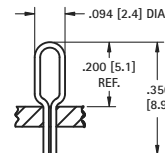

MATERIAL: .016 (.40) x .028 (.71) Phosphor Bronze Silver Plate
Mtg Hole: .040 (1.0)

CAT. NO. 5020

STANDARD

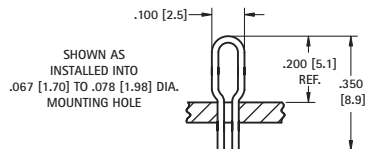

MATERIAL: .020 (.50) Dia. Phosphor Bronze Silver Plate
Mtg Hole: .073 (1.9)

CAT. NO. 5023

LARGE

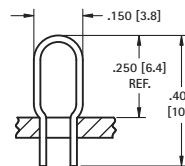

MATERIAL: .020 (.50) Dia. Phosphor Bronze Silver Plate
Mtg Hole: .114 (2.9)

CAT. NO. 5024

ALLIGATOR CLIPS



- Solder connection with strain relief
- Insulated or non-insulated
- Large clip also accepts standard banana plug



MATERIAL: Clip: Steel, Nickel Plate; Insulator: Vinyl

SMALL CLIP

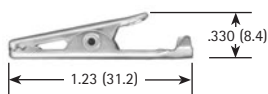

CAT. NO.	INSULATOR COLOR
5033	NONE
5034	RED
5035	BLACK
5036	GREEN
5037	YELLOW

JAW SPREAD: .236 (6.0) max.

MEDIUM CLIP

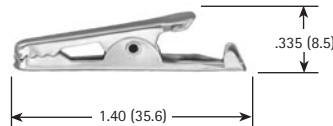

CAT. NO.	INSULATOR COLOR
5038	NONE
5039	RED
5040	BLACK

JAW SPREAD: .236 (6.0) max.

LARGE CLIP

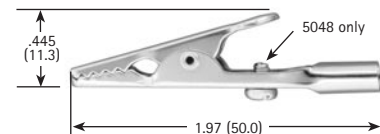

CAT. NO.	INSULATOR COLOR
5044	NONE
5045	RED
5046	BLACK
5048*	NONE

JAW SPREAD: .315 (8.0) max.

*with screw